

CHELSEA® 267 SERIES

Constant Mesh PTO for Allison 3000 and 4000 Series Transmissions

Quality knows quality, that is why Allison chose Chelsea to join their engineers in developing PTOs specifically for the Allison World Transmissions. The versatile 267 Series is a constant mesh PTO that exceeds the torque capacity of a 6-Bolt PTO while offering the tighter sealing of a 10-Bolt pattern. The 267 Series is an excellent choice for variable displacement piston pumps used in refuse and snow and ice removal applications. It is available in multiple speed ratios and output types, including Chelsea's popular 360° rotatable flange. The 267 Series also features the SuperTorque™ option which provides up to 20% more torque capacity than a standard 267 Series.

Applications:

- Refuse
- Aerial
- Snow & Ice Removal
- Fire & Rescue

Product Features and Benefits:

- Constant Mesh – Applications that require live power at all times.
- Multiple speed ratios and output options.
- Torque – SuperTorque™ gears available for 20% higher intermittent torque ratings.
- Protection – Wet Spline design virtually eliminates spline fretting and can increase shaft life by a factor of ten.
- Backlash – None to set.
- Confidence – Two year warranty.

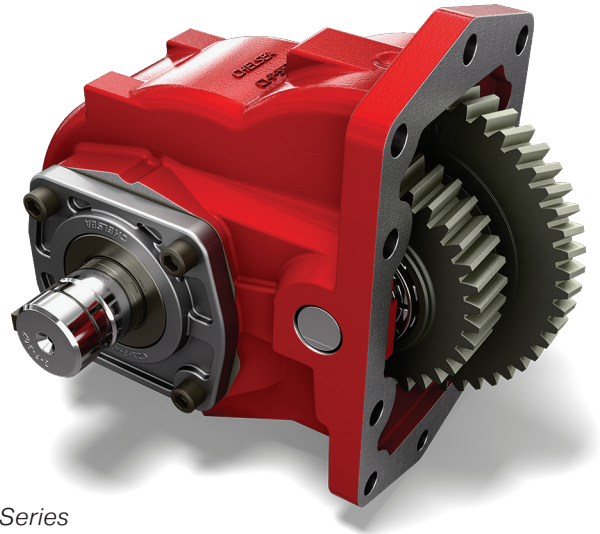

267 Series



267 Series Power Take-Off – Allison

Model Number Designator

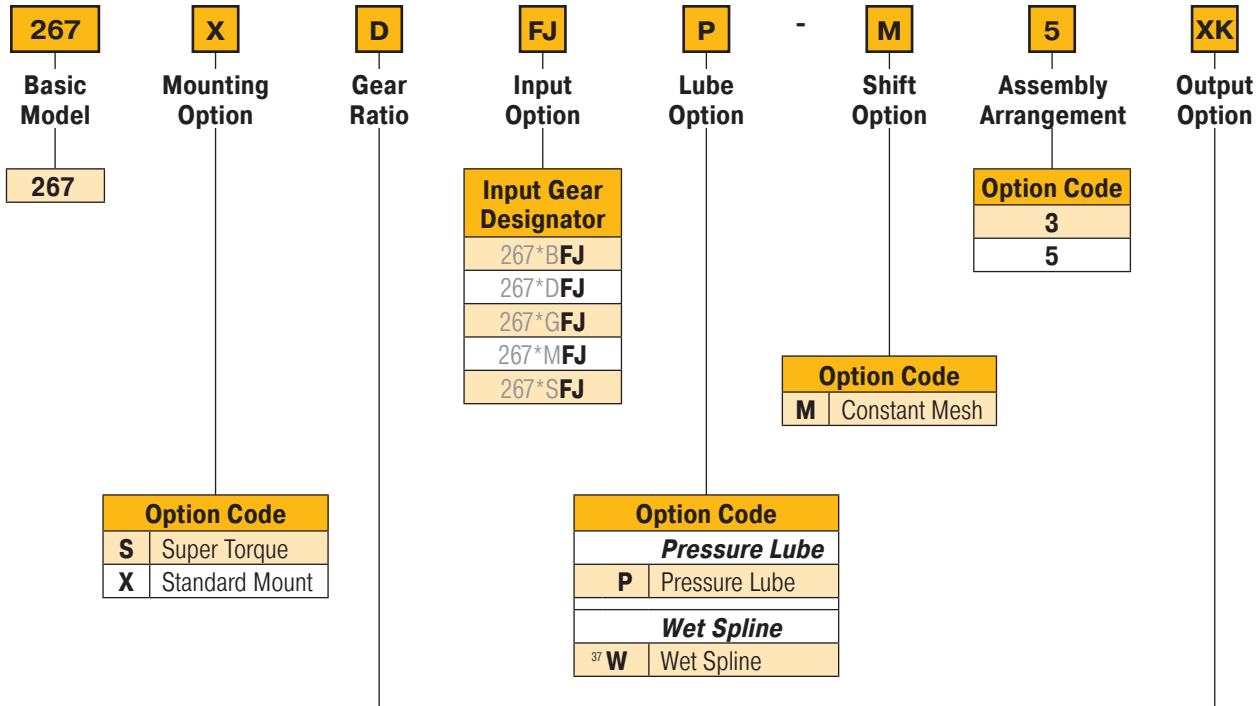

¹³ Available assembly 5 only
²³ Must be purchased with Wet Spline
³⁷ Automatically pressure lubed with Wet Spline
⁵⁹ Same as XK except rotated 90°

267 Series Power Take-Off – Allison

Dimensions & Specifications – For PTO output information see application catalog

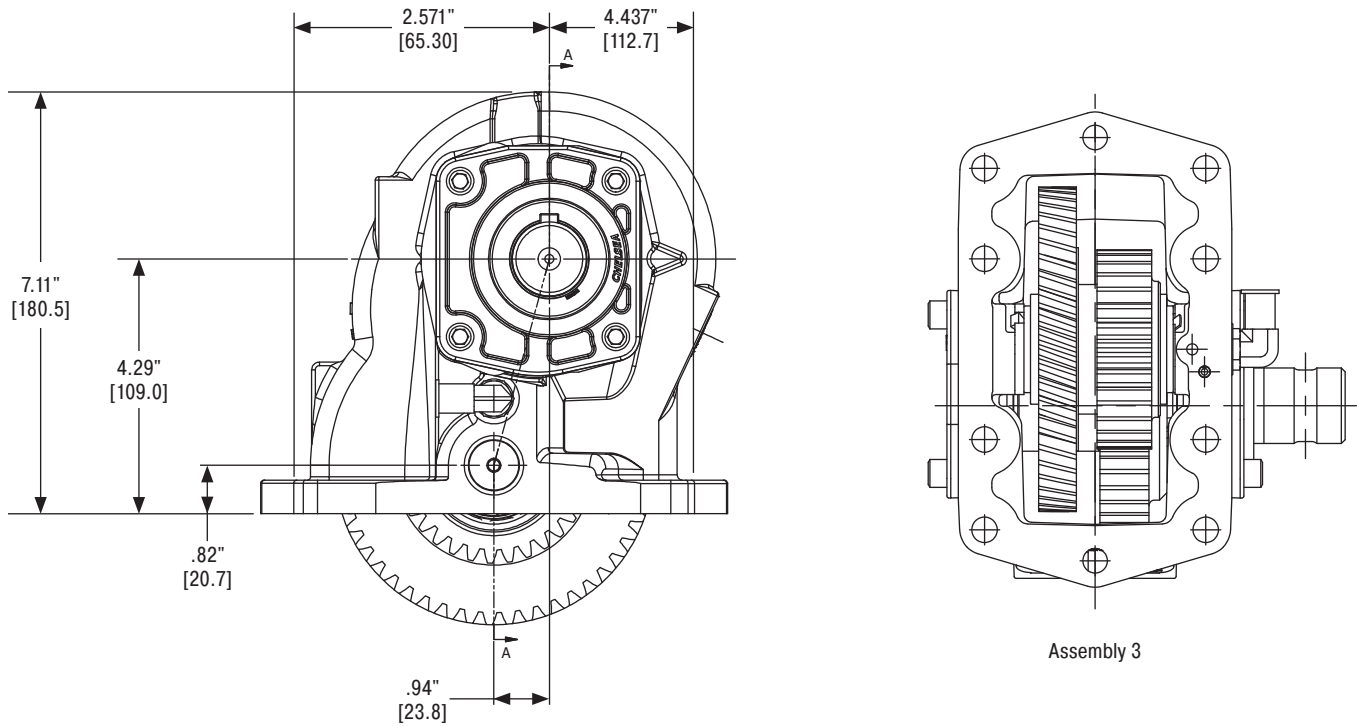

Specifications Chart	Approximate Weight: 35 lbs. [16 kg]								
	267*B	267*D	267*G	267*M	267*S	267SB	267SD	267SG	267SS
Intermittent Torque Rating lb-ft [N-m]	335 [454]	335 [454]	300 [407]	265 [359]	250 [339]	402 [545]	402 [545]	360 [488]	265 [359]
HP Rating for Intermittent Service									
At 500 RPM of Output Shaft HP [kW]	32 [24]	32 [24]	29 [21]	25 [19]	24 [18]	38 [29]	38 [29]	34 [36]	25 [19]
At 1000 RPM of Output Shaft HP [kW]	64 [48]	64 [48]	57 [43]	50 [38]	48 [36]	77 [57]	77 [57]	69 [51]	50 [38]

Parker Hannifin Corporation
Chelsea Products Division
 8225 Hacks Cross Road
 Olive Branch, MS 38654 USA
 phone 1-888-PH4-TRUK (1-888-744-8785)
 chd_support@support.parker.com
 www.parker.com/chelsea

HY25-0002-B1/US November 2025

© 2025 Parker Hannifin Corporation

